

AMD

FITTING DCI QUICK & BUTTWELDING



**PRODUCT
CATALOG**

APPLICATION



Water Supply



Hot & Cold



Marine &
Mining



Fire Protection



Gas

Dear Valued Customer

PT. AMD PIPING SYSTEM Founded in 2020, it is a company operating in the most complete piping sector in Indonesia. Offers products such as Pipes, Fittings, Valves, Accessories, Machinery, Equipment & Piping System.

We focus on serving customers in the Infrastructure, Housing, Commercial, Industrial, Mining, Maritime, Agricultural and Plantation sectors.

AMD's goal is to offer high-quality products and services to meet customer needs.

AMD manages its business in accordance with standards

ISO 9001:2015

Quality Management System Certificate

ISO 14001:2015

Environmental Management System Certificate

ISO 45001:2018

Safety and Health Management System Certificate



PT. AMD PIPING SYSTEM Berdiri sejak tahun 2020 merupakan Perusahaan yang bergerak di bidang perpipaan terlengkap di Indonesia. Menawarkan produk-produk seperti Pipa, Fitting, Valve, Accesories, Mesin, Peralatan & Sistem Perpipaan.

Kami fokus melayani pelanggan di bidang Infrastruktur, Perumahan, Komersial, Industrial, Pertambangan, Kelautan, Pertanian dan Perkebunan.

Tujuan AMD adalah menawarkan produk dan layanan berkualitas tinggi untuk memenuhi kebutuhan pelanggan .

AMD mengelola usaha sesuai dengan standard

ISO 9001:2015

Sertifikat Sistem Manajemen Mutu

ISO 14001:2015

Sertifikat Sistem Manajemen Lingkungan

ISO 45001:2018

Sertifikat Sistem Manajemen Keselamatan dan Kesehatan



PIPING SYSTEM TOTAL SOLUTION

Pipes, Fittings, Mesin & Tools
Valves, Accesories, Piping System



Water Supply



Drainage & Sewerage



Electrical & Communication



Hot & Cold



Marine & Mining



Agriculture



Fire Protection



Gas

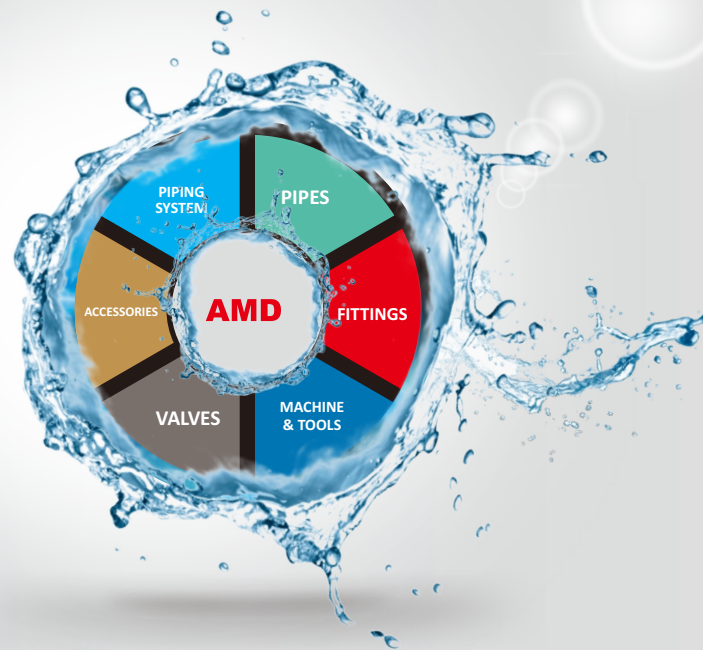

CONTENTS

1.	FITTING GROOVED COUPLING	04
2.	FITTING CARBON STEEL BUTT WELDED	15

Illustration of commercial mark included
in Pipe's and Fitting's publicity materials :

AMD

All above trademarks are registered trademark of PT. AMD Piping System , Please be informed that the products labeled those trademarks are products of PT. AMD Piping System. All rights reserved

AMD Grooved Coupling adalah alat sambungan cepat yang digunakan untuk menghubungkan dan melepaskan pipa dengan mudah dan cepat, tanpa memerlukan alat khusus. "DCI" adalah singkatan dari "Ductile Cast Iron" atau "Ductile Iron," yaitu besi tuang nodular yang memiliki sifat ketangguhan tinggi, tahan korosi dan mampu menahan tekanan tinggi.



Coupling
PE 100
DN 50 - 300

01



Transition Coupling
PE 100
DN 50 - 300

02



U-Bolted
Mechanical Tee Threaded
DN 50 - 300

03



Tee
Grooved Mechanical
DN 50 - 300

04



Elbow 90°
DN 50 - 300

05



Elbow 45°
DN 50 - 300

06



Tee
DN 50 - 300

07



Cross
DN 50 - 300

08



Reducing Tee Grooved
DN 40x32 - 300x250

09



Reducer Grooved
DN 50 - 300

10



Flange Adaptor
JIS 10K, PN 16
DN 50 - 300

11



Flange Grooved
JIS 10K, PN 16
DN 50 - 300

12



Cap
DN 50 - 300

13



Cap Threaded
DN 50 - 300

14



Coupling
DN 50 - 300

15

Cross

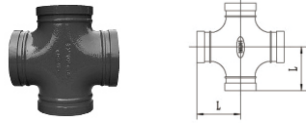

SIZE	Pipe OD mm/in	Working Pressure PSI/MPa	Cross (Short)	UL	FM
			L		
32	42.4	300	60	UL	FM
1¼	1.66	2.07	2.362	UL	FM
40	48.3	300	60	UL	FM
1½	1.900	2.07	2.362	UL	FM
50	60.3	300	70	UL	FM
2	2.375	2.07	2.755	UL	FM
65	73.0	300	76	UL	FM
2½	2.875	2.07	2.992	UL	FM
65	76.1	300	76	UL	FM
2½	3.000	2.07	2.992	UL	FM
80	88.9	300	86	UI	FM
3	3.500	2.07	3.386	UL	FM
100	108.0	300	102	UL	FM
4	4.252	2.07	4.016	UL	FM
100	114.3	300	102	UL	FM
4	4.500	2.07	4.016	UL	FM

Elbow 45°

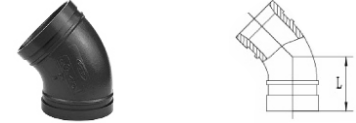

SIZE	Pipe OD mm/in	Working Pressure PSI/MPa	Elbow 45°	UL	FM
			L		
25	33.7	300	38	UL	FM
1	1.315	2.07	1.496	UL	FM
32	42.4	300	44	UL	FM
1¼	1.660	2.07	1.732	UL	FM
40	48.3	300	44	UL	FM
1½	1.900	2.07	1.732	UL	FM
50	60.3	300	51	UL	FM
2	2.375	2.07	2.007	UL	FM
65	73.0	300	57	UL	FM
2½	2.875	2.07	2.244	UL	FM
65	76.1	300	57	UL	FM
2½	3.000	2.07	2.244	UL	FM
80	88.9	300	64	UI	FM
3	3.500	2.07	2.519	UL	FM
100	108.0	300	76	UL	FM
4	4.252	2.07	2.992	UL	FM
100	114.3	300	76	UL	FM
5	4.500	2.07	2.992	UL	FM
125	133.0	300	83	UL	FM
5	5.250	2.07	3.267	UL	FM
125	139.7	300	83	UL	FM
5	5.500	2.07	3.267	UL	FM
125	141.3	300	83	UL	FM
5	5.563	2.07	3.267	UL	FM
150	159.0	300	89	UL	FM
6	6.260	2.07	3.503	UL	FM
150	165.1	300	89	UL	FM
6	6.500	2.07	3.503	UL	FM
150	168.3	300	89	UL	FM
6	6.625	2.07	3.503	UL	FM
200	216.3	300	108	UL	FM
8	8.516	2.07	4.251	UL	FM
250	219.1	300	108	UL	FM
8	8.625	2.07	4.251	UL	FM
250	267.4	300	121	UL	FM
10	10.528	2.07	4.763	UL	FM
250	273.0	300	121	UL	FM
10	10.750	2.07	4.763	UL	FM
300	323.9	300	133	UL	FM
12	12.750	2.07	5.236	UL	FM

Cross



SIZE	Pipe OD mm/in	Working Pressure PSI/MPa	Cross (Long)	UL	FM
			L		
125	139.7	300	123	UL	FM
5	5.500	2.07	4.843	UL	FM
125	141.3	300	123	UL	FM
6	5.563	2.07	4.843	UL	FM
150	165.1	300	140	UL	FM
6	6.500	2.07	5.511	UL	FM
150	168.3	300	140	UL	FM
6	6.625	2.07	5.511	UL	FM
200	219.1	300	175	UL	FM
8	8.625	2.07	6.889	UL	FM
250	273.0	300	215	UI	FM
10	10.750	2.07	8.464	UL	FM

Reducing
Tee

SIZE	Pipe OD mm/in	Working Pressure PSI/MPa	L1	L2	UL	FM
			mm	mm		
80x80x100	88.9x88.9x114.3	300	115	37.5	UL	FM
3x3x4	3.500x3.500x4.500	2.07	5.512	1.476	UL	FM
80x80x150	88.9x88.9x165.1	300	140	43.5	UL	FM
3x3x6	3.500x3.500x6.500	2.07	5.512	1.713	UL	FM
100x100x150	114.3x114.3x165.1	300	140	53	UL	FM
4x4x6	4.500x4.500x6.500	2.07	5.512	2.087	UL	FM

Elbow 90° (Short)

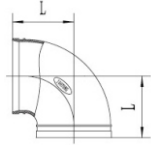

SIZE	Pipe OD mm/in	Working Pressure PSI/MPa	Elbow 90° (Short)	UL	FM
			L		
25	33.7	300	57		
1	1.315	2.07	2.244	UL	FM
32	42.4	300	60	UL	FM
1¼	1.660	2.07	2.362		
40	48.3	300	60	UL	FM
1½	1.900	2.07	2.362		
50	57.0	300	70		
2	2.244	2.07	2.755		
50	60.3	300	70	UL	FM
2	2.375	2.07	2.755		
65	73.0	300	76	UI	FM
2½	2.875	2.07	2.992		
65	76.1	300	76	UL	FM
2½	3.000	2.07	2.992		
80	88.9	300	86	UL	FM
3	3.500	2.07	3.386		
100	108.0	300	102	UL	FM
4	4.252	2.07	4.016		
100	114.3	300	102	UL	FM
4	4.500	2.07	4.016		
125	133.0	300	123	UL	FM
5	5.250	2.07	4.843		
125	139.7	300	123	UL	FM
5	5.500	2.07	4.843		
125	141.3	300	123	UL	FM
5	5.563	2.07	4.843		
150	159.0	300	140	UL	FM
6	6.260	2.07	5.511		
150	165.1	300	140	UL	FM
6	6.500	2.07	5.511		
150	168.3	300	140	UL	FM
6	6.625	2.07	5.511		
200	216.3	300	175	UL	FM
8	8.516	2.07	6.889		
200	219.1	300	175	UL	FM
8	8.625	2.07	6.889		
250	267.4	300	215		
10	10.528	2.07	8.464		
250	273.0	300	215	UL	FM
10	10.750	2.07	8.464		
300	318.5	300	245		
12	12.539	2.07	9.645		
300	323.9	300	245	UL	FM
12	12.750	2.07	9.645		
350	377.0	300	280		
14	14.843	2.07	11.024		

Elbow 90° (Long)

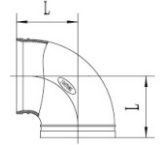

SIZE	Pipe OD mm/in	Working Pressure PSI/MPa	Elbow 90° (Long)	UL	FM
			L		
25	33.7	300	57		
1	1.315	2.07	2.24		
32	42.4	300	70	UL	FM
1½	1.660	2.07	2.755		
40	48.3	300	70	UL	FM
1¼	1.900	2.07	2.755		
50	60.3	300	80	UL	FM
2	2.375	2.07	3.267		
65	73.0	300	95	UL	FM
2½	2.875	2.07	3.74		
65	76.1	300	95	UL	FM
2½	3.000	2.07	3.74		
80	88.9	300	108	UI	FM
3	3.500	2.07	4.251		
100	114.3	300	127	UL	FM
4	4.500	2.07	5		
125	139.7	300	140		
5	5.500	2.07	5.511		
125	141.3	300	140		
5	5.563	2.07	5.511		
150	165.1	300	165	UL	FM
6	6.500	2.07	6.496		
150	168.3	300	165	UL	FM
6	6.625	2.07	6.496		
200	219.1	300	197	UL	FM
8	8.625	2.07	7.755		
350	377.0	300	280		
14	14.843	2.07	11.024		

Elbow 22.5°



SIZE	Pipe OD mm/in	Working Pressure PSI/MPa	Elbow 22.5°	UL	FM
			L		
25	33.7	300	38.5	UL	FM
1	1.315	2.07	1.516		
32	42.4	300	44	UL	FM
1¼	1.660	2.07	1.732		
40	48.3	300	44	UL	FM
1½	1.900	2.07	1.732		
50	60.3	300	48	UL	FM
2	2.375	2.07	1.89		
65	73.0	300	51	UL	FM
2½	2.875	2.07	2		
65	76.1	300	51	UI	FM
2½	3.000	2.07	2		
80	88.9	300	57	UL	FM
3	3.500	2.07	2.244		
100	108.0	300	73	UL	FM
4	4.252	2.07	2.874		
100	114.3	300	73	UL	FM
4	4.500	2.07	2.874		
125	139.7	300	73	UL	FM
5	5.500	2.07	2.874		
125	141.3	300	73	UL	FM
5	5.563	2.07	2.874		
150	159.0	300	79	UL	FM
6	6.260	2.07	3.11		
150	165.1	300	79	UL	FM
6	6.500	2.07	3.11		
150	168.3	300	79	UL	FM
6	6.625	2.07	3.11		
200	219.1	300	83	UL	FM
8	8.625	2.07	3.27		
250	273.0	300	111	UL	FM
10	10.750	2.07	4.37		
300	323.9	300	124	UL	FM
12	12.750	2.07	4.88		

Elbow 11.25°

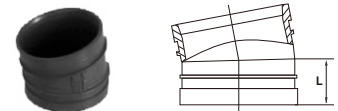

SIZE	Pipe OD mm/in	Working Pressure PSI/MPa	Elbow 11.25°	UL	FM
			L		
25	33.7	300	35	UL	FM
1	1.315	2.07	1.377		
32	42.4	300	35	UL	FM
1¼	1.660	2.07	1.377		
40	48.3	300	35	UL	FM
1½	1.900	2.07	1.377		
50	60.3	300	35	UL	FM
2	2.375	2.07	1.377		
65	73.0	300	38	UL	FM
2½	2.875	2.07	1.496		
65	76.1	300	38	UI	FM
2½	3.000	2.07	1.496		
80	88.9	300	38	UL	FM
3	3.500	2.07	1.496		
100	108.0	300	44	UL	FM
4	4.252	2.07	1.732		
100	114.3	300	48	UL	FM
4	4.500	2.07	1.889		
125	139.7	300	51	UL	FM
5	5.500	2.07	2.007		
125	141.3	300	51	UL	FM
5	5.563	2.07	2.007		
150	159.0	300	51	UL	FM
6	6.260	2.07	2.007		
150	165.1	300	51	UL	FM
6	6.500	2.07	2.007		
150	168.3	300	51	UL	FM
6	6.625	2.07	2.007		
200	219.1	300	51	UL	FM
8	8.625	2.07	2.007		
250	273.0	300	54	UL	FM
10	10.750	2.07	2.125		
300	323.9	300	57	UL	FM
12	12.750	2.07	2.244		

Drainase
Elbow

SIZE	Pipe OD mm/in	Working Pressure PSI/MPa	L	A	B	UL	FM
			mm	mm	mm		
50	60.3	300	83	65	37.5	UL	FM
2	2.375	2.07	3.268	2.559	1.476		
65	73.0	300	95	70	43.5	UL	FM
2½	2.875	2.07	3.740	2.756	1.713		
80	88.2	300	108	70	53	UL	FM
3	3.500	2.07	4.252	2.756	2.087		
100	114.3	300	127	70	66	UL	FM
4	4.500	2.07	5	2.756	2.598		
150	168.3	300	165	70	92.5	UL	FM
6	6.625	2.07	6.496	2.756	3.642		
200	219.1	300	197	70	116	UL	FM
8	8.625	2.07	7.756	2.756	4.567		

Tee

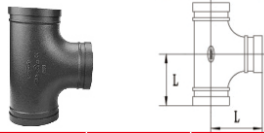

SIZE	Pipe OD mm/in	Working Pressure PSI/MPa	Tee (Short)	UL	FM
			L		
25	33.7	300	57	UL	FM
1	1.315	2.07	2.244	UL	FM
32	42.4	300	60	UL	FM
1¼	1.660	2.07	2.362	UL	FM
40	48.3	300	60	UL	FM
1½	1.900	2.07	2.362	UL	FM
50	60.3	300	70	UL	FM
2	2.375	2.07	2.755	UL	FM
65	73.0	300	76	UL	FM
2½	2.875	2.07	2.992	UL	FM
65	76.1	300	76	UI	FM
2½	3.000	2.07	2.992	UI	FM
80	88.9	300	86	UL	FM
3	3.500	2.07	3.386	UL	FM
100	108.0	300	102	UL	FM
4	4.252	2.07	4.016	UL	FM
100	114.3	300	102	UL	FM
4	4.500	2.07	4.016	UL	FM
125	133.0	300	123	UL	FM
5	5.250	2.07	4.843	UL	FM
125	139.7	300	123	UL	FM
5	5.500	2.07	4.843	UL	FM
125	141.3	300	123	UL	FM
5	5.563	2.07	4.843	UL	FM
125	159.0	300	140	UL	FM
6	6.260	2.07	5.511	UL	FM
150	165.1	300	140	UL	FM
6	6.500	2.07	5.511	UL	FM
150	168.3	300	140	UL	FM
6	6.625	2.07	5.511	UL	FM
200	216.3	300	175	UL	FM
8	8.516	2.07	6.889	UL	FM
200	219.1	300	175	UL	FM
8	8.625	2.07	6.889	UL	FM
250	267.4	300	215		
10	10.527	2.07	8.464		
250	273.0	300	215	UL	FM
10	10.750	2.07	8.464	UL	FM
300	323.9	300	245	UL	FM
12	12.750	2.07	9.645	UL	FM

Tee

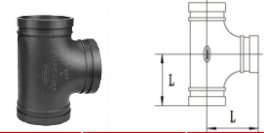

SIZE	Pipe OD mm/in	Working Pressure PSI/MPa	Tee (Long)	UL	FM
			L		
25	42.4	300	70	UL	FM
1¼	1.660	2.07	2.755	UL	FM
40	48.3	300	70	UL	FM
1½	1.900	2.07	2.755	UL	FM
50	60.3	300	83	UL	FM
2	2.375	2.07	3.267	UL	FM
65	73.0	300	95	UL	FM
2½	2.875	2.07	3.74	UL	FM
65	76.1	300	95	UL	FM
2½	3.000	2.07	3.74	UL	FM
80	88.9	300	108	UI	FM
3	3.500	2.07	4.251	UI	FM
100	114.3	300	127	UL	FM
4	4.500	2.07	5	UL	FM
125	139.7	300	140	UL	FM
5	5.500	2.07	5.511	UL	FM
150	165.1	300	165	UL	FM
6	6.500	2.07	6.496	UL	FM
150	168.3	300	165	UL	FM
5	6.625	2.07	6.496	UL	FM
200	219.1	300	197	UL	FM
8	8.625	2.07	7.755	UL	FM

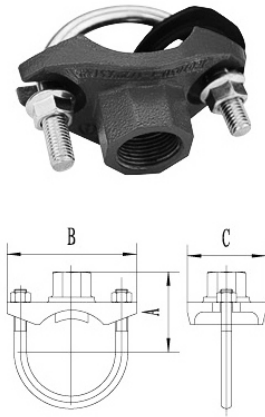
U - Bolt Mechanical
Tee Threaded

SIZE	Pipe OD mm/in	Working Pressure PSI/MPa	Bolt Size No.-Size mm	Dimensions L mm/in			Hole Cutting Dimension	UL	FM
				A	B	C			
25x15	33.7x21.3	300	M10x25	39	76	43	24	UL	FM
1x½	1.327x0.839	2.07		1.535	2.922	1.654	0.945		
25x20	33.7x26.9	300	M10x25	46	84	43	24	UL	FM
1¾	1.327x1.059	2.07		1.811	3.307	1.693	0.945		
25x25	33.7x33.7	300	M10x28.5	50	92	57	24		
1x1	1.327x1.327	2.07		1.969	3.622	2.244	0.945		
32x15	42.4x21.3	300	M10x28.5	43	90	56	30	UL	FM
1¾x½	1.669x0.839	2.07		1.693	3.543	2.205	1.181		
32/x20	42.4x26.9	300	M10x28.5	45	90	56	30	UL	FM
1¾x¾	1.669x1.059	2.07		1.772	3.543	2.205	1.181		
32x25	42.4x33.7	300	M10x28.5	50	90	56	30		FM
1¾x1	1.669x1.327	2.07		1.969	3.543	2.205	1.181		
32x25	42.4x33.7	300	M10x28.5	50	90	56	32	UL	FM
1¾x1	1.669x1.327	2.07		1.969	3.543	2.205	1.260		
40x15	48.3x21.3	300	M10x28.5	43	93	59	30	UL	FM
1¾x½	1.900x0.839	2.07		1.693	3.661	2.323	1.181		
40x20	48.3x26.9	300	M10x28.5	54	93	59	30	UL	FM
1¾x¾	1.900x1.059	2.07		2.126	3.661	2.323	1.181		
40x25	48.3x33.7	300	M10x28.5	58	93	59	30		FM
1¾x1	1.900x1.327	2.07		2.283	3.661	2.323	1.181		
40x25	48.3x33.7	300	M10x28.5	58	93	59	32	UL	FM
1¾x1	1.900x1.327	2.07		2.283	3.661	2.323	1.260		
50x15	60.3x21.3	300	M10x30	54	96	59	30	UL	FM
2x½	2.375x0.839	2.07		2.126	3.780	2.323	1.181		
50x20	60.3x26.9	300	M10x30	56	96	59	30	UL	FM
2x¾	2.375x1.059	2.07		2.205	3.780	2.323	1.181		
50x25	60.3x33.7	300	M10x30	66	96	59	30		FM
2x1	2.375x1.327	2.07		2.598	3.780	2.323	1.181		
50x25	60.3x33.7	300	M10x30	66	96	29	32	UL	FM
2x1	2.375x1.327	2.07		2.598	3.780	2.323	1.260		
65x15	73x21.3	300	M10x30	60	110	59	30	UL	FM
2½x½	2.874x0.839	2.07		2.362	4.331	2.323	1.181		
65x20	73x26.9	300	M10x30	63	110	59	30	UL	FM
2½x¾	2.874x1.059	2.07		2.480	4.331	2.323	1.181		
65x25	73x33.7	300	M10x30	70	110	59	30		FM
2½x1	2.874x1.327	2.07		2.756	4.331	2.323	1.181		
65x25	73x33.7	300	M10x30	70	110	59	32	UL	FM
2½x1	2.874x1.327	2.07		2.756	4.331	2.323	1.260		
65x32	73x42.4	300	M10x30	64	113.5	74.2	51	UL	
2½x1¼	2.874x1.669	2.07		2.520	4.469	2.921	2.007		
65x15	76.1x21.3	300	M10x30	61	110	59	30	UL	FM
2½x1½	2.996x0.839	2.07		2.402	4.331	2.323	1.181		
65x20	76.1x26.9	300	M10x30	67	110	59	30	UL	FM
2½x¾	2.996x1.059	2.07		2.638	4.331	2.323	1.181		
65x25	76.1x33.7	300	M10x30	74	110	59	30		FM
2½x1	2.996x1.327	2.07		2.913	4.331	2.323	1.181		
65x25	76.1x33.7	300	M10x30	74	110	59	32	UL	FM
2½x1	2.996x1.327	2.07		2.913	4.331	2.323	1.260		
65x25	76x42.4	300	M10x30	65	113.5	74.2	51	UL	
2½x1¼	2.996x1.669	2.07		2.559	4.469	2.921	2.007		
80x15	88.9x21.3	300	M12x30	68	131.5	67.5	38	UL	
3x½	3.5x0.839	2.07		2.677	5.177	2.657	1.496		
80x20	88.9x26.9	300	M12x30	69	131.5	67.5	38	UL	
3x¾	3.5x1.059	2.07		2.717	5.177	2.657	1.496		
80x25	88.9x33.7	300	M12x30	73.5	131.5	67.5	38	UL	
3x1	3.5x1.327	2.07		2.894	5.177	2.657	1.496		
80x32	88.9x42.4	300	M12x30	70	132	78	51	UL	
3x1	2.878x1.669	2.07		2.756	5.197	3.071	2.007		
100x20	114.3x21.3	300	M12x40	79.5	154	70	38	UL	
4x¼	4.5x0.839	2.07		3.130	6.063	2.756	1.496		
100x20	114.3x26.9	300	M12x40	80.5	154	70	38	UL	
4x¾	4.5x1.059	2.07		3.169	6.063	2.756	1.496		
100x25	114.3x33.7	300	M12x40	86.5	154	70	38	UL	
4x1	4.5x1.327	2.07		3.406	6.063	2.756	1.496		
100x32	114.3x42.4	300	M12x40	82.5	154	78	51	UL	
4x1¼	4.5x1.669	2.07		3.248	6.063	3.071	2.007		

Mechanical Tee Groove

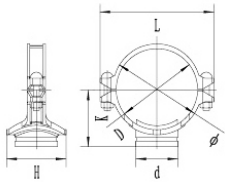

SIZE	Pipe OD mm/in	Working Pressure PSI/MPa	Bolt Size No.-Size mm	Dimensions L mm/in				Hole Cutting Dimension	UL	FM
				s	L	K	H			
125x80 5x3	139.7x88.9 5.500x3.500	300 2.07	2-M16x75	168 6.614	220 8.661	113 4.449	136 5.354	86 3.386	UL	FM
150x65 6x2½	159.0x76.1 6.260x2.996	300 2.07	2-M16x85	187 7.362	237 9.331	121 4.764	122 4.409	81 3.189		
150x80 6x3	159.0x88.9 6.260x3.500	300 2.07	2-M16x85	187 7.362	237 9.331	121 4.764	136 5.354	86 3.386		
150x100 6x4	159.0x108.0 6.260x4.252	300 2.07	2-M16x85	187 7.362	237 9.331	125 4.921	158 6.220	114 4.488		
150x50 6x4	159.0x114.3 6.260x4.500	300 2.07	2-M16x85	187 7.362	237 9.331	125 4.921	158 6.220	114 4.488		
150x50 6x2	165.1x60.3 6.500x2.375	300 2.07	2-M16x85	194 7.638	247 9.724	123 4.842	99 3.898	61 2.402	UL	FM
150x65 6x2½	165.1 x 76.1 6.500x2.996	300 2.07	2-M16x85	194 7.638	247 9.724	123 4.842	123 4.843	81 3.189	UL	FM
150x80 6x3	165.1 x 88.9 6.500x3.500	300 2.07	2-M16x85	194 7.638	247 9.724	125 4.921	136 5.354	86 3.386	UL	FM
150x100 6x4	165.1x114.3 6.500x4.500	300 2.07	2-M16x85	194 7.638	247 9.724	125 4.921	158 6.220	114 4.488	UL	FM
150x25 6x1	168.3 x 33.7 6.625 x 1.327	300 2.07	2-M16x85	198 7.795	248 9.764	125 4.921	79 3.110	38 1.496	UL	FM
150x32 6x1½	168.3x42.4 6.625 x 1.669	300 2.07	2-M16x85	198 7.795	248 9.764	125 4.921	84 3.307	46 1.811	UL	FM
150x40 6x1½	168.3 x 48.3 6.625x1.900	300 2.07	2-M16x85	198 7.795	248 9.764	125 4.921	94 3.701	51 2.007	UL	FM
150x50 6x2	168.3x60.3 6.625x2.375	300 2.07	2-M16x85	198 7.795	248 9.764	125 4.921	99 3.898	61 2.401	UL	FM
150x65 6x2½	168.3x73 6.625x2.874	300 2.07	2-M16x85	198 7.795	248 9.764	128 5.039	122 4.409	81 3.189		
150x65 6x2½	168.3x76.1 6.625x2.996	300 2.07	2-M16x85	198 7.795	248 9.764	128 5.039	122 4.409	81 3.189	UL	FM
150x80 6x3	168.3x88.9 6.625x3.500	300 2.07	2-M16x85	198 7.795	248 9.764	130 5.118	136 5.354	86 3.385	UL	FM
150x100 6x4	168.3 x 114.3 6.625x4.500	300 2.07	2-M16x85	198 7.795	248 9.764	128 5.039	157 6.181	114 4.488		
200x65 8x2½	216x76.1 8.504x2.996	300 2.07	2-M16x100	247 9.724	302 11.890	150 5.906	127 5.000	81 3.189		
200x50 8x2	219.1 x 60.3 8.625x2.375	300 2.07	2-M16x100	250 9.843	302 11.890	152 5.984	99 3.898	61 2.402	UL	FM
200x65 8x2½	219.1x73 8.625x2.874	300 2.07	2-M16x100	250 9.843	302 11.890	152 5.964	130 5.118	81 3.189		
200x65 8x2½	219.1 x 76.1 8.625x2.996	300 2.07	2-M16x100	250 9.843	302 11.890	152 5.984	130 5.118	81 3.189	UL	FM
200x80 8x3	219.1 x 88.9 8.625x3.500	300 2.07	2-M16x100	250 9.843	302 11.890	152 5.984	137 5.394	86 3.386	UL	FM
200x100 8x4	219.1 x 114.3 8.625x4.500	300 2.07	2-M16x100	250 9.843	304 11.969	153 6.024	162 6.378	114 4.488	UL	FM
200x150 8x6	219.1 x 168.3 8.625 x 6.625	300 2.07	2-M16x100	250 9.843	304 11.969	158 6.850	210 8.425	160 6.299		
250x65 10x2½	273.0*73 10.748*2.874	300 2.07	2-M22x130	307 12.087	376 14.803	186 7.323	131 5.157	81 3.189		
250x100 10x4	273.0*114.3 10.748*4.500	300 2.07	2-M22x130	307 12.087	376 14.803	186 7.323	161 6.339	114 4.488		

HDPE Transition Coupling

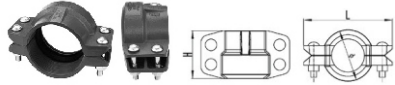

SIZE	Pipe OD mm/in	Working Pressure PSI/MPa	Bolt Size No.-Size mm	Dimensions L mm/in		
				Ø	L	H
50	60.3	300	4-M12x60	84	146	78
2	2.375	2.07		3.07	5.748	3.071
80	88.9	300	4-M12x75	112	174	79
3	3.5	2.07		4.409	6.85	3.011
	110	300	4-M12x75	137.6	192	80
	4.33	2.07		5.417	7.559	3.150
100	114	300	4-M12x75	142	208	95
4	4.5	2.07		5.591	8.189	3.74
	161	300	4-M12x75	188	246	85
	6.339	2.07		7.402	9.685	3.346
150	168.3	300	4-M16x85	198	280	96
6	6.626	2.07		7.795	11.024	3.78
200	219.1	300	4-M16x85	260	342	107
8	8.626	2.07		10.236	13.465	4.213
250	273	300	4-M20x120	314	424	128
10	10.748	2.07		12.362	16.693	5.039
300	323.9	300	4-M20x120	368	470	129
12	10.748	2.07		14.488	18.504	5.079

HDPE Coupling

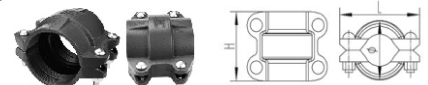

SIZE	Pipe OD mm/in	Working Pressure PSI/MPa	Bolt Size No.-Size mm	Dimensions L mm/in		
				Ø	L	H
50	60.3	300	4-M12x60	83	120	116
2	2.375	2.07		3.268	4.724	4.567
	63	300	4-M10x60	89	116	105
	2.48	2.07		3.504	4.567	4.134
80	88.9	300	4-M12x75	114	166	118
3	3.5	2.07		4.5	6.535	4.647
	110	300	4-M12x75	137	180	110
	4.33	2.07		5.394	7.087	4.331
100	114	300	4-M12x75	143	201	147
4	4.5	2.07		5.63	7.913	5.787
	161	300	4-M12x75	188	235	118
	6.339	2.07		7.402	9.252	4.646
150	168.3	300	4-M16x85	202	252	150
6	6.626	2.07		7.953	9.921	5.906
	200	300	4-M16x85	238.2	309	127
	7.874	2.07		9.378	12.165	5.00
200	219.1	300	4-M16x85	258	320	152
8	8.626	2.07		10.157	12.598	5.984
	252	300	4-M16x100	288	350	141
	9.921	2.07		11.339	13.780	5.551
250	273	300	4-M20x100	313	390	165
10	10.748	2.07		12.323	15.354	6.496
300	323.9	300	4-M20x120	367	455	183
12	10.748	2.07		14.449	17.913	7.205

Push Lock Coupling

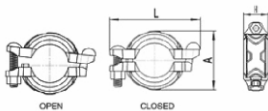

SIZE	Pipe OD mm/in	Working Pressure PSI/MPa	Bolt Size No.-Size mm	Torque Value (N - M)	Dimensions L mm/in			UL	FM
					A	L	H		
25	33.7	450	M10x55	90	57.3	98.6	47.6	UL	FM
1	1.32	3.1							
32	42.4	450	M10x60	90	64	107.5	47	UL	FM
1¼	1.67	3.1							
40	48.3	450	M10x60	90	70	114	47.5	UL	FM
1	1.9	3.1							
50	60.3	365	M10x65	90	84	128	48	UL	FM
2	2.37	2.5							
65	73	365	M16x70	100	96.4	140.3	48	UL	FM
2½	2.87	2.5							
65	76.1	365	M10x70	100	99.5	140.3	48	UL	FM
2½	3	2.5							
80	88.9	365	M12x80	120	113.5	168	48	UL	FM
3	3.5	2.5							
100	108	365	M12x80	140	133	187.5	50	UL	FM
4	4.25	2.5							
100	114.3	365	M12x80	140	143	194	50	UL	FM
4	4.5	2.5							
125	133	365	M12x85	150	165.5	221	50	UL	FM
5	5.24	2.5							
125	139.7	365	M12x85	150	172	228	50	UL	FM
5	5.5	2.5							
125	141.3	365	M12x85	150	173.7	229.5	50	UL	FM
5	5.56	2.5							
125	159	365	M12x90	150	190	251	51	UL	FM
6	6.26	2.5							
150	165.1	365	M12x90	150	198	256	51	UL	FM
6	6.5	2.5							
150	168.3	365	M12x90	150	201	259	51	UL	FM
6	6.63	2.5							

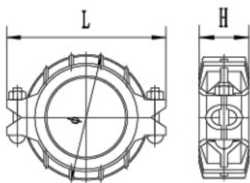
Reducing Flexible
Coupling

SIZE	Pipe OD mm/in	Working Pressure PSI/MPa	Bolt Size	Dimensions L mm/in			UL	FM
				No.-Size mm	ø	L		
40x32	48,3x42,4	300	2-M10x45	73.6	111	44	UL	FM
1½x1¼	1.900x1.669	2.07		2.899	4.37	1.732		
50x40	60,3x48,3	300	2-M10x55	90	129	47	UL	FM
2x1½	2,375x1,900	2.07		3.543	5.079	1.850		
65x40	73,0x48,3	300	2-M10x55	101	137	48	UL	FM
2½x1½	2,874x1,900	2.07		3.976	5.394	1.890		
65x50	73,0x60,3	300	2-M10x55	101	137	48	UL	FM
2½x2	2,974x2,375	2.07		3.976	5.394	1.890		
65x40	76,1x48,3	300	2-M16x55	105	140	48	UL	FM
2½x1½	2,996x 1,900	2.07		4.134	5.512	1.890		
65x50	76,1x60,3	300	2-M10x55	105	140	48	UL	FM
2½x2	2,996x2,375	2.07		4.134	5.512	1.890		
65x65	76,1x73,0	300	2-M10x55	100.4	141	47	UL	FM
2½x2½	2,996x2,874	2.07		3.953	5.551	1.85		
80x40	88,9x48,3	300	2-M12x65	120	164	48	UL	FM
3x1½	3,500x 1,900	2.07		4.724	6.457	1.890		
80x50	88,9x60,3	300	2-M12x65	120	164	48	UL	FM
3x2	3,500x2,375	2.07		4.724	6.457	1.890		
80x65	88,9x73,0	300	2-M12x65	120	164	48	UL	FM
3x2½	3,500x2,874	2.07		4.724	6.457	1.890		
80x65	88,9x76,1	300	2-M12x65	120	164	48	UL	FM
3x2½	3,500x2.996	2.07		4.724	6.457	1.890		
100x40	114,3x48,3	300	2-M12x65	150	195	49	UL	FM
4x1½	4,500x1.900	2.07		5.906	7.677	1.929		
100x50	114,3x60,3	300	2-M12x65	150	195	49	UL	FM
4x2	4,500x2,375	2.07		5.906	7.677	1.929		
100x65	114,3x73	300	2-M12x65	150	195	49	UL	FM
4x2½	4,500x2.874	2.07		5.906	7.677	1.929		
100x65	114,3x76,1	300	2-M12x65	150	195	49	UL	FM
4x2½	4,500x2.996	2.07		5.906	7.677	1.929		
100x80	114,3x88,9	300	2-M12x65	150	195	49	UL	FM
4x3	4,500x3,500	2.07		5.906	7.677	1.929		
150x100	165,1x114,3	300	2-M12x75	203	235	50		
6x4	6,500x4,500	2.07		7.992	9.252	1.969		
150x80	168,3x88,9	300	2-M12x75	203	235	50	UL	FM
6x3	6,625x3,500	2.07		7.992	9.252	1.969		
150x100	168,3x114,3	300	2-M12x175	203	235	50	UL	FM
6x4	6,625x4,500	2.07		7.992	9.252	1.969		
200x150	219,1x168,3	300	2-M16x110	264	313	60	UL	FM
8x6	8,625x6,625	2.07		10.394	12.323	2.362		

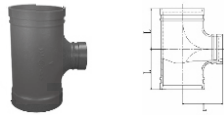
Reducing Tee
Grooved

SIZE	Pipe OD mm/in Dxd	Working Pressure PSI/MPa	Dimension	UL	FM
			L		
40x32	48,3x48,3x42,4	400	60		
1½x¼	1.900x1.900x1.660	2.75	2.362		
50x32	60,3x60,3x42,4	400	70	UL	FM
2x¼	2,375x2,375x1,660	2.75	2.755		
50x40	60,3x60,3x48,3	400	70	UL	FM
2x1½	2,375x2,375x1,900	2.75	2.755		
65x25	73,0x73,0x33,7	400	76	UL	FM
2½x1	2,875x2,875x1,315	2.75	2.992		
65x32	73,0x73,0x42,4	400	76	UL	FM
2½x1¼	2,875x2,875x1,660	2.75	2.992		
65x40	73,0x73,0x48,3	400	76	UL	FM
2½x1½	2,875x2,875x1,900	2.75	2.992		
65x50	73,0x73,0x60,3	400	76	UI	FM
2½x2	2,875x2,875x2,375	2.75	2.992		
65x25	76,1 x 76,1 x 33,7	400	76	UL	FM
2½x1	3.000x3.000x1.315	2.75	2.992		
65x32	76,1x76,1x42,4	400	76	UL	FM
2½x1¼	3.000x3.000x1.660	2.75	2.992		
65x40	76,1x76,1x48,3	400	76	UL	FM
2½1½	3.000x3.000x1.900	2.75	2.992		
65x50	76,1x76,1x60,3	232	76	UL	
2½x2	3.000x3.000x2.375	1.6	2.992		
80x25	88,9x88,9x33,7	400	86	UL	FM
3x1	3,500x3,500x1,315	2.75	3.386		
80x32	88,9x88,9x42,4	400	86	UL	FM
3x1¼	3,500x3,500x1,660	2.75	3.386		
80x40	88,9x88,9x48,3	400	86	UL	FM
3x1½	3,500x3,500x1,900	2.75	3.386		
80x50	88,9x88,9x60,3	400	86	UL	FM
3x2	3,500x3,500x2,375	2.75	3.386		
80x65	88,9x88,9x73,0	400	86	UL	FM
3x2½	3,500x3,500x2,875	2.75	3.386		
80x65	88,9x88,9x76,1	232	86	UL	FM
3x2½	3,500x3,500x3,000	1.6	3.386		
100x50	108x108x60,3	400	102		
4x2	4,252x4,252x2,375	2.75	4.016		

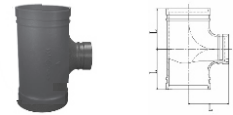
Reducing Tee
Grooved

SIZE	Pipe OD mm/in Dxd	Working Pressure PSI/MPa	Dimension	UL	FM
			L		
100x65	108x108x76,1	400	102		
4x2½	4,252x4,252x2,875	2.75	4.016		
100x80	108x108x88,9	400	102		
4x3	4,252x4,252x3,000	2.75	4.016		
100x50	114,3x114,3x60,3	400	102	UL	FM
4x2	4,500x4,500x2,375	2.75	4.016		
100x65	114,3x114,3x73,0	400	102	UL	FM
4x2½	4,500x4,500x2,875	2.75	4.016		
100x65	114,3x114,3x76,1	400	102	UL	FM
4x2½	4,500x4,500x3,000	2.75	4.016		
100x80	114,3x114,3x88,9	400	102	UL	FM
4x3	4,500x4,500x3,500	2.75	4.016		
125x50	139,7x139,7x60,3	300	122	UL	FM
5x2	5,500x5,500x2,375	2.07	4.803		
125x65	139,7x139,7x76,1	300	122	UL	FM
5x2½	5,500x5,500x3,000	2.07	4.803		
125x80	139,7x139,7x88,9	300	122	UL	
5x3	5,500x5,500x3,500	2.07	4.803		
125x100	139,7x139,7x114,3	300	122		
5x4	5,500x5,500x4,500	2.07	4.803		
125x50	141,3x141,3x60,3	300	122	UL	
5x2	5,563x5,563x2,375	2.07	4.803		
125x65	141,3x141,3x76,1	300	122	UL	
5x2/2½	5,563x5,563x3,000	2.07	4.803		
125x80	141,3x141,3x88,9	300	122	UL	
5x3	5,563x5,563x2,375	2.07	4.803		
150x60	159x159x76,1	400	140		
6x2½	6,260x6,260x2,875	2.75	5.512		
150x80	159x159x88,9	400	140		
6x3	6,260x6,260x3,000	2.75	5.512		
150x100	159x159x108	400	140		
6x4	6,260x6,260x4,252	2.75	5.512		
150x125	159x159x114,3	400	140		
6x4	6,260x6,260x4,500	2.75	5.512		

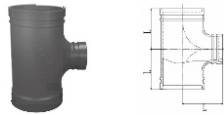
Reducing Tee
Grooved

SIZE	Pipe OD mm/in Dxd	Working Pressure PSI/MPa	Dimension	UL	FM
			L		
150x50	1651x1651x603	400	140	UL	FM
6x2	6500x6500x2375	2.75	5.511		
150x65	1651x1651x761	400	140	UL	FM
6x2½	6.500x6.500x3.000	2.75	5.511		
150x80	1651x1651x889	400	140	UL	FM
6x3	6500x6500x3500	2.75	5.511		
150x100	1651x1651x1143	400	140	UL	FM
6x4	6.500x6.500x4.500	2.75	5.511		
150x125	1651x1651x1397	400	140		FM
6x5	6.500x6.500x5.500	2.75	5.511		
150x40	1683x1683x483	400	140	UL	FM
6x1	6625x6625x1900	2.75	5.511		
150x50	1683x1683x603	400	140	UL	FM
6x2	6625x6625x2375	2.75	5.511		
150x65	1683x1683x730	400	140	UL	
6x2/2	6625x6625x2875	2.75	5.511		
150x65	1683x1683x761	400	140	UL	FM
6x2	6625x6625x3000	2.75	5.511		
150x80	1683x1683x889	400	140	UL	FM
6x3	6625x6625x3500	2.75	5.511		
150x100	1683x1683x1143	400	140	UL	FM
6x4	6625x6625x4500	2.75	5.511		
150k125	1683x1683x1397	400	140		
6x5	6625x6625x5500	2.75	5.511		
200x80	2163x2163x889	300	175		
8x3	8.516x8.516x3.000	2.07	6.890		
200x125	2163x2163x1397	300	175		
8x5	8.516x8.516x3.500	2.07	6.890		
200x50	2191x2191x603	300	175		
8x2	8625x8625x2375	2.07	6.889		
200x65	2193x2193x763	232	175	UL	
8x2	8.625x8.625x3.000	1.6	6.889		
200x80	2191x2191x889	232	175	UL	
8x3	8.625x8.625x3.500	1.6	6.889		

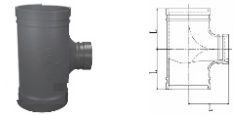
Reducing Tee
Grooved

SIZE	Pipe OD mm/in Dxd	Working Pressure PSI/MPa	Dimension	UL	FM
			L		
200x100	2191x2191x1143	300	175	UL	FM
8x4	8.625x8.625x4.500	2.07	6.889		
200x125	2191x2191x1413	232	175	UL	
8x5	8625x8625x5563	1.6	6.889		
200x150	2191x2191x1651	232	175	UL	FM
8x6	8.625x8.625x6.500	1.6	6.889		
200x150	2191x2191x1683	300	175	UL	FM
8x6	8625x8625x6625	2.07	6.889		
250x80	2674x2674x889	300	215		
10x3	10.527x10.527x3.000	2.07	8.464		
250x100	2674x2674x1143	300	215		
10x4	10.527x10.527x4.500	2.07	8.464		
250x150	2674x2674x1651	300	215		
10x6	10.527x10.527x6.500	2.07	8.464		
250x200	2674x2674x2163	300	215		
10x8	10.527x10.527x8.516	2.07	8.464		
250x100	2730x2730x1143	300	215	UL	
10x4	10.750x10.750x4.500	2.07	8.465		
250x125	2730x2730x1397	300	215		
10x5	10.750x10.750x5.500	2.07	8.465		
250x150	2730x2730x1651	300	215		
10x6	10.750x10.750x6.500	2.07	8.465		
250x150	273x273x168.3	300	215	UL	FM
10x6	10.750x10.750x6.625	2.07	8.465		
250x200	273.0x273.0x219.1	300	215	UL	FM
10x8	10.750x10.750x8.625	2.07	8.465		
300x100	3239x3239x1143	300	245	UL	FM
12x4	12.750x12.750x4.500	2.07	9.646		
300x150	3239x3239x1651	300	245		
12x6	12.750x12.750x6.500	2.07	9.646		
300x200	3239x3239x2191	300	245	UL	
12x8	12.750x12.750x8.625	2.07	9.646		
300x250	3239x3239x2730	300	245	UL	FM
12x10	12.750x12.750x10.75	2.07	9.646		

Carbon Steel Butt weld Fittings kami, yang diproduksi dengan dua model SHC40 dan SGP, dengan standar tertinggi dalam hal daya tahan dan kinerja. Dirancang untuk menahan kondisi yang sulit dalam industri seperti minyak dan gas, pembangkit listrik, dan pemrosesan kimia, fitting ini menawarkan solusi yang sempurna dan kuat untuk sistem perpipaan Anda.

Keunggulan Produk

- **Material:** Dibuat dari baja karbon paduan berkualitas tinggi, memastikan kekuatan dan umur panjang yang luar biasa.
- **Sambungan Tahan Bocor:** Dirancang dengan presisi untuk hasil pas yang sempurna dan kinerja tanpa kebocoran.
- **Permukaan Dalam Halus:** Meminimalkan kehilangan tekanan, mengurangi gesekan, dan mencegah korosi.
- **Aplikasi Serbaguna:** Cocok untuk berbagai aplikasi industri, termasuk lingkungan bertekanan tinggi dan suhu ekstrem.
- **Cost-Effective:** Tahan lama dan andal, mengurangi biaya perawatan dan waktu henti.

Aplikasi Produk

- Water Supply
- Marine & Mining
- Fire Protection
- Hot & Cold Water
- Gas

Standard Produk

ANSI/ASME B16.9
SEAMLESS

JIS B2304 / B2311
WELDED



Elbow 90°



SIZE	SCH40		SGP	
	TEBAL (MM)	BERAT (KG)	TEBAL (MM)	BERAT (KG)
½"	2.77	0.08	2.80	0.08
¾"	2.87	0.08	2.80	0.10
1"	3.38	0.15	3.20	0.15
1¼"	3.56	0.25	3.50	0.25
1½"	3.68	0.36	3.50	0.35
2"	3.91	0.65	3.80	0.63
2½"	5.16	1.29	4.20	1.12
3"	5.49	2.03	4.20	1.58
4"	6.02	3.85	4.50	2.91
5"	6.55	6.51	4.50	4.99
6"	7.11	10.10	5.00	7.09
8"	8.18	20.40	5.80	14.40
10"	9.27	36.10	6.60	25.40
12"	10.31	57.80	6.90	38.10

Concentric Reducers



SIZE	SCH40		SGP	
	TEBAL (MM)	BERAT (KG)	TEBAL (MM)	BERAT (KG)
2½ x 1	5.16 X 3.38	0.57	4.2 X 3.2	0.59
2½ x 1¼	5.16 X 3.56	0.60	4.2 X 3.5	0.59
2½ x 1½	5.16 X 3.68	0.64	4.2 X 3.5	0.59
2½ x 2	5.16 X 3.91	0.70	4.2 X 3.8	0.59
3 x 1	5.49 X 3.38	0.78	4.2 X 3.2	0.72
3 x 1¼	5.49 X 3.56	0.78	4.2 X 3.5	0.72
3 x 1½	5.49 X 3.68	0.78	4.2 X 3.5	0.72
3 x 2	5.49 X 3.91	0.78	4.2 X 3.8	0.72
3 x 2½	5.49 X 5.16	0.78	4.2 X 4.2	0.72
4 x 1	6.02 X 3.38	1.10	4.5 X 3.2	1.10
4 x 1¼	6.02 X 3.56	1.15	4.5 X 3.5	1.10
4 x 1½	6.02 X 3.68	1.20	4.5 X 3.5	1.10
4 x 2	6.02 X 3.91	1.19	4.5 X 3.8	1.10
4 x 2½	6.02 X 5.16	1.32	4.5 X 4.2	1.10
4 x 3	6.02 X 5.49	1.41	4.5 X 4.2	1.10
5 x 2	6.55 X 3.91	2.00	4.5 X 3.8	1.70
5 x 2½	6.55 X 5.16	2.06	4.5 X 4.2	1.70
5 x 3	6.55 X 5.49	2.17	4.5 X 4.2	1.70
5 x 4	6.55 X 6.02	2.35	4.5 X 4.5	1.70
6 x 2½	7.11 X 5.16	3.00	5.0 X 4.2	2.60
6 x 3	7.11 X 5.49	2.96	5.0 X 4.2	2.60
6 x 4	7.11 X 6.02	3.15	5.0 X 4.5	2.60
6 x 5	7.11 X 6.55	3.42	5.0 X 4.5	2.60
8 x 4	8.18 X 6.02	5.07	5.8 X 4.5	4.10
8 x 5	8.18 X 6.55	5.35	5.8 X 4.5	4.10
8 x 6	8.18 X 7.11	5.65	5.8 X 5.0	4.10
10 x 4	9.27 X 6.02	8.50	6.6 X 4.5	-
10 x 5	9.27 X 6.55	8.60	6.6 X 4.5	-
10 x 6	9.27 X 7.11	8.90	6.6 X 5.0	6.70
10 x 8	9.27 X 8.18	9.80	6.6 X 5.8	6.70

Tee



Reducing Tee



SIZE	SCH40		SGP	
	TEBAL (MM)	BERAT (KG)	TEBAL (MM)	BERAT (KG)
1/2"	2.77	-	2.80	0.12
3/4"	2.87	0.13	2.80	0.17
1"	3.38	0.23	3.20	0.32
1 1/4"	3.56	0.42	3.50	0.56
1 1/2"	3.68	0.78	3.50	0.78
2"	3.91	1.15	3.80	1.16
2 1/2"	5.16	2.12	4.20	1.94
3"	5.49	3.02	4.20	2.55
4"	6.02	4.75	4.50	4.27
5"	6.55	7.53	4.50	6.17
6"	7.11	10.50	5.00	9.32
8"	8.18	22.80	5.80	17.50
10"	9.27	40.40	6.60	29.70
12"	10.31	56.10	6.90	32.00

SIZE	SCH40		SGP	
	TEBAL (MM)	BERAT (KG)	TEBAL (MM)	BERAT (KG)
2 1/2 x 1	5.16 X 3.38	1.86	4.2 X 3.2	1.70
2 1/2 x 1 1/4"	5.16 X 3.56	1.80	4.2 X 3.5	1.80
2 1/2 x 1 1/2"	5.16 X 3.68	1.89	4.2 X 3.5	1.90
2 1/2 x 2	5.16 X 3.91	2.00	4.2 X 3.8	1.90
3 x 1	5.49 X 3.38	2.60	4.2 X 3.2	2.10
3 x 1 1/4"	5.49 X 3.56	2.65	4.2 X 3.5	2.20
3 x 1 1/2"	5.49 X 3.68	2.67	4.2 X 3.5	2.30
3 x 2	5.49 X 3.91	2.76	4.2 X 3.8	2.30
3 x 2 1/2"	5.49 X 5.16	2.89	4.2 X 4.2	2.40
4 x 1	6.02 X 3.38	4.00	4.5 X 3.2	3.80
4 x 1 1/4"	6.02 X 3.56	4.20	4.5 X 3.5	3.80
4 x 1 1/2"	6.02 X 3.68	4.22	4.5 X 3.5	3.80
4 x 2	6.02 X 3.91	4.32	4.5 X 3.8	4.00
4 x 2 1/2"	6.02 X 5.16	4.36	4.5 X 4.2	4.00
4 x 3	6.02 X 5.49	4.42	4.5 X 4.2	4.00
6 x 2 1/2"	7.11 X 5.16	9.51	5.0 X 4.2	8.50
6 x 3	7.11 X 5.49	9.56	5.0 X 4.2	8.70
6 x 4	7.11 X 6.02	9.70	5.0 X 4.5	9.00
6x5	7.11 X 6.55	9.88	5.0 X 4.5	9.00
8 x 3	8.18 X 5.49	19.00	5.8 X 4.2	-
8 x 4	8.18 X 6.02	20.50	5.8 X 4.5	16.50
8 x 5	8.18 X 6.55	19.50	5.8 X 4.5	16.50
8 x 6	8.18 X 7.11	19.90	5.8 X 5.0	17.00
10 x 3	9.27 X 5.49	34.00	6.6 X 4.2	-
10 x 4	9.27 X 6.02	34.00	6.6 X 4.5	-
10 x 5	9.27 X 6.55	35.00	6.6 X 4.5	-
10 x 6	9.27 X 7.11	35.00	6.6 X 5.0	28.00
10 x 8	9.27 X 8.18	36.00	6.6 X 5.8	28.00

AMD

PT. AMD PIPING SYSTEM



Office

Golden Building, Jl Raya Legok
- Karawaci No. 57-58 Klp. Dua,
Kec. Kelapa Dua, Kabupaten
Tangerang - Banten

Factory

Kawasan Industri JIPS Blok D, Jalan
Raya Semarang-Demak KM 14.7
Desa Batu, Kec. karangtengah,
Kab.Demak, Jawa Tengah



 **0811 1177 595**

 **amdiping.com**

Telp. (+6221) 3893 0000, 389 3333
E-mail. amdiping@gmail.com